





Diva is the new exponent of the elegance by Isa: a perfect balance between design, aesthetics and functionality that enhances the food appeal of the product and gives a touch of charme to the environment, thanks to the volumes, that fit together in a harmonious way, the wide transparent surfaces of the glass frame (without front pillars and with lateral pillars that have reduced thickness) and thanks to the sober and refined nuances of the front and side panels. Diva is equipped with on-board or remote latest generation condenser with double ventilation refrigeration system and inversion defrost cycle. The glass frame with a single glass and laminated sides allow to keep a good balance between performance and aesthetics. The temperature control is adjusted by a control unit and by an anti-fog control system.

Diva è la nuova interprete dell'eleganza secondo Isa: un equilibrio perfetto tra design, estetica e funzionalità che esalta il food appeal del prodotto e dona un tocco di classe all'ambiente di consumo grazie ai volumi che si raccordano in maniera armoniosa, alle ampie superfici trasparenti del castello vetri (senza montanti frontali e con i laterali a ridotto spessore) e alle nuance sobrie e ricercate dei pannelli frontali e laterali. Diva è equipaggiata con unità condensatrici a bordo o remote di ultima generazione con sistema di refrigerazione a doppia ventilazione e sbrinamento ad inversione di ciclo. Il castello vetri in vetro singolo e i fianchi stratificati consentono di mantenere un ottimo equilibrio tra performance e estetica. Il controllo della temperatura è affidato ad una centralina elettronica e sistema per il controllo dell'anti-appannamento dei vetri.

-  **ENERGY SAVING**
LED + EC Fan motor
-  **INSTALLATION**
Plug-in
-  **TEMPERATURE**
-20/+2°C
-  **DEFROST**
Reverse Cycle
-  **CLIMATIC CLASS**
7





Diva Catalog - Catalogo

Model Modello	Code Codice	Condensing unit included Unità condensatrice a bordo			Condensing unit not included Senza unità condensatrice a bordo	Remote condensing unit included (up to 20 meters) Unità condensatrice remota compresa (fino a 20 metri)		Remote condensing unit included semi-hermetic Unità condensatrice remota compresa semi-ermetica		
		R404A Air Aria	Water Acqua	Air+Water Aria+Acqua		Air Aria	Air+Water Aria+Acqua	Air Aria	Air+Water Aria+Acqua	
RV H120	120	DVG0012000L	*****	****	****	****	*****	****	*****	****
	170	DVG0017000L	*****	****	****	****	*****	****	*****	****
	120+50 COMBI	DVG0120500L	*****	****	****	****	*****	****	*****	****
	220	DVG0022000L	*****	****	****	****	*****	****	*****	****
	170+50 COMBI	DVG0170500L	*****	****	****	****	*****	****	*****	****
	AE45	DVG0AE4500L	*****	****	****	****	*****	****	*****	****
RV H140	120	DVG0012000L	*****	****	****	****	*****	****	*****	****
	170	DVG0017000L	*****	****	****	****	*****	****	*****	****
	120+50 COMBI	DVG0120500L	*****	****	****	****	*****	****	*****	****
	220	DVG0022000L	*****	****	****	****	*****	****	*****	****
	170+50 COMBI	DVG0170500L	*****	****	****	****	*****	****	*****	****
	AE45	DVG0AE4500L	*****	****	****	****	*****	****	*****	****

Available Colours - Colori disponibili

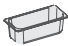
Model Modello	Side Panel Fianco laterale	Front panel Pannello frontale				
	Grigio	White	Bisque	Clay	Pearl Gray	
120	•					*****
170						*****
220						*****
120+50						*****
170+50						*****
AE45						*****

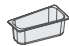
Plus 1	Plus 2	Electronic RGB lighting basement Illuminazione basamento RGB	Stainless steel containers Vaschette inox			
						
			5 Lt 360 x 165 x 120h 9001990000005 ***** each/cad.	5 Lt 360 x 250 x 80h 9001990000017 ***** each/cad.	5 Lt 360 x 185 x 120h (trapezoidali) 9290100024200 ***** each/cad.	
*****	*****	*****	12	8	-	
*****	*****	*****	18	12	-	
-	-	*****	18 [6+12]	14 [6+8]	-	
*****	*****	*****	24	16	-	
-	-	*****	24 [6+18]	18 [6+12]	-	
*****	*****	*****	13	+KitSup ***** 9001700000043	9	+KitSup ***** 9001700000044
*****	*****	*****	12	8	-	
*****	*****	*****	18	12	-	
-	-	*****	18 [6+12]	14 [6+8]	-	
*****	*****	*****	24	16	-	
-	-	*****	24 [6+18]	18 [6+12]	-	
*****	*****	*****	13	+KitSup ***** 9001700000043	9	+KitSup ***** 9001700000044
*****	*****	*****	12	8	-	
*****	*****	*****	18	12	-	
-	-	*****	18 [6+12]	14 [6+8]	-	
*****	*****	*****	24	16	-	
-	-	*****	24 [6+18]	18 [6+12]	-	
*****	*****	*****	13	+KitSup ***** 9001700000043	9	+KitSup ***** 9001700000044
*****	*****	*****	14	+KitSup ***** 9001700000042	14	+KitSup ***** 9001700000042

Diva **Technical features** - Caratteristiche tecniche

Section - Sezioni

H120

Standard

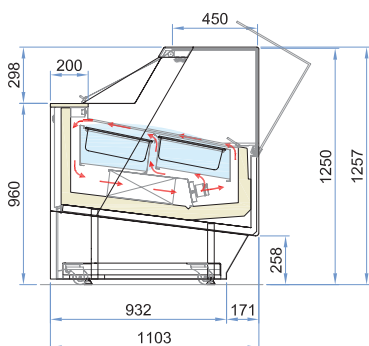

Plus 1

Double evaporator with single rear flow delivery
Doppio evaporatore con singola mandata d'aria a flusso posteriore

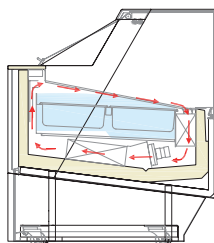

Plus 2

Double evaporator with double rear flow delivery
Doppio evaporatore con doppia mandata d'aria a flusso posteriore

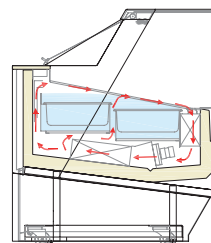

		120	170	220
External dimensions (LxDxH) Dimensioni esterne [LxPxH]	H120	1176 x 1103 x 1257mm	1671 x 1103 x 1257 mm	2166 x 1103 x 1257 mm
	H140	1176 x 1103 x 1408 mm	1671 x 1103 x 1408 mm	2166 x 1103 x 1408 mm
Capacity [gross/net] Capacità [lorda/netta]	H120	719 / 147 lt	1059 / 216 lt	1399 / 285 lt
	H140	865 / 147 lt	1273 / 216 lt	1680 / 285 lt
Net weight Peso netto	H120	300 kg	375 kg	470 kg
	H140	325 kg	385 kg	480 kg
Refrigeration Refrigerazione	Ventilated - Doppia Ventilazione			
Refrigerant Refrigerante	R404A			
Climatic class Classe climatica	4			
Operating conditions Condizioni ambientali	30 °C / 55 %RH			
Cabinet capacity range Temperatura di regolazione	-20/+2 °C			
Product temperature Temperatura prodotto	-16/-14 °C			
Compressor [type] Compressore [tipologia]	1 Hermetic - 1 Ermetico		2 Hermetic - 2 Ermetico	
Defrost Sbrinamento	Reverse Cycle / Inversione di Ciclo			
Power supply Alimentazione	230 V / 1 Ph / 50 Hz		400 V / 3 Ph / 50 Hz	
Electrical input [standard] Assorbimento elettrico	1240 W / 6 A		1720 W / 3 A	2700 W / 4,2 A
Electrical input [defrost] Assorbimento elettrico	2300 W / 11 A		2950 W / 4,9 A	6300 W / 8,5 A

Section - Sezioni

H140

Standard

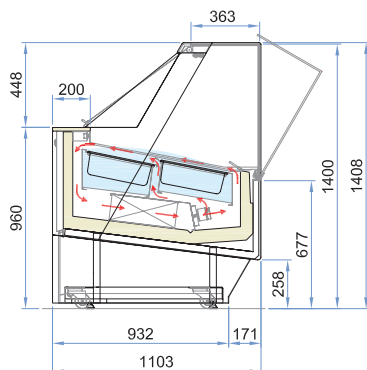

Plus 1

Double evaporator with single rear flow delivery
 Doppio evaporatore con singola mandata d'aria a flusso posteriore

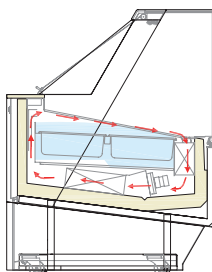

Plus 2

Double evaporator with double rear flow delivery
 Doppio evaporatore con doppia mandata d'aria a flusso posteriore

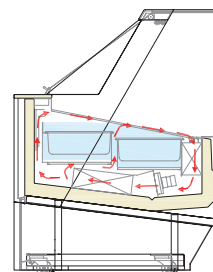

AE 45	120+50 COMBI	170+50 COMBI
1835 x 1103 x 1257 mm	1671 x 1103 x 1257 mm	2166 x 1103 x 1257 mm
1835 x 1103 x 1408 mm	1671 x 1103 x 1408 mm	2166 x 1103 x 1408 mm
946 / 193 lt	1059 / 216 lt	1399 / 285 lt
1136 / 193 lt	1273 / 216 lt	1680 / 285 lt
378 kg	385 kg	480 kg
400 kg	408 kg	505 kg
Ventilated - Doppia Ventilazione		
R404A		
4		
30 °C / 55 %RH		
-20/+2 °C		
-16/-14 °C		
2 Hermetic - 2 Ermetico		
Reverse Cycle / Inversione di Ciclo		
400 V / 3 Ph / 50 Hz		
1720 W / 3 A	1720 W / 3 A	2700 W / 4,2 A
2950 W / 4,9 A	2950 W / 4,9 A	6300 W / 8,5 A

Diva **Optionals** - Elementi opzionali

Item	Accessorio	Mod.	Code	Price
Grey cone holder	Portaconi completo grigio	-	9001390900802	*****
Cone holder complete of toppings container	Portaconi completo di vaschette portagranelle	-	9001390900801	*****
Consolle scoop washer with water tap RIGHT	Consolle lavaporzionatore con rubinetto DX	-	9001920000267	*****
Consolle scoop washer with shower selfrolling RIGHT	Cons. lavaporzionatore con doccia avvolgitubo DX	-	9001920000268	*****
Wheel kit [only linear modules]	Kit ruote [solo moduli lineari]	120	9001390900813	*****
		170 220	9001390900814	*****
Ice lolly container - 250 x 360 x 43h	Vaschetta portaghiaccioli - 250 x 360 x 43h		9001990000014	*****
Stainless steel tray - 495 x 360 [n.1]	Vassoio inox - 495 x 360 [n.1]	120	9001390900815	*****
		170 220		
Stainless steel tray kit [3+3]	Kit Vassoio inox [3+3]	AE 45	9001390900818	*****
Tray portion - 250 x 360 [n.1]	Vassoio monoporzioni - 250 x 360 [n.1]	-	9001390900816	*****